



---

# Horus

COMELIT'S NEW INTEGRATED SOLUTION

---

[www.comelitgroup.com](http://www.comelitgroup.com)

 **Comelit**  
Passion. Technology. Design.

# HORUS: INTEGRATED SECURITY BY COMELIT

 Constant system monitoring

The increasing complexity of buildings in terms of dimensions and systems has made it increasingly necessary to offer people and their surroundings greater and constant protection. At the same time, demand is increasing for systems which are not only capable of guaranteeing the physical safety of people and safeguarding buildings, but which can also integrate with one another and be managed in a unified manner to considerably simplify the role of Security Managers. Horus, the new system manager software, presents itself as the perfect solution to these demands, as it allows the integrated management of all security systems: fire protection, intruder alarm, video surveillance and IP video entry.



 Centralised and remote management of video entry phone calls



 Instant intervention in the event of fire



Total protection for the areas covered



# THE SOFTWARE THAT CANCELS OUT DISTANCE

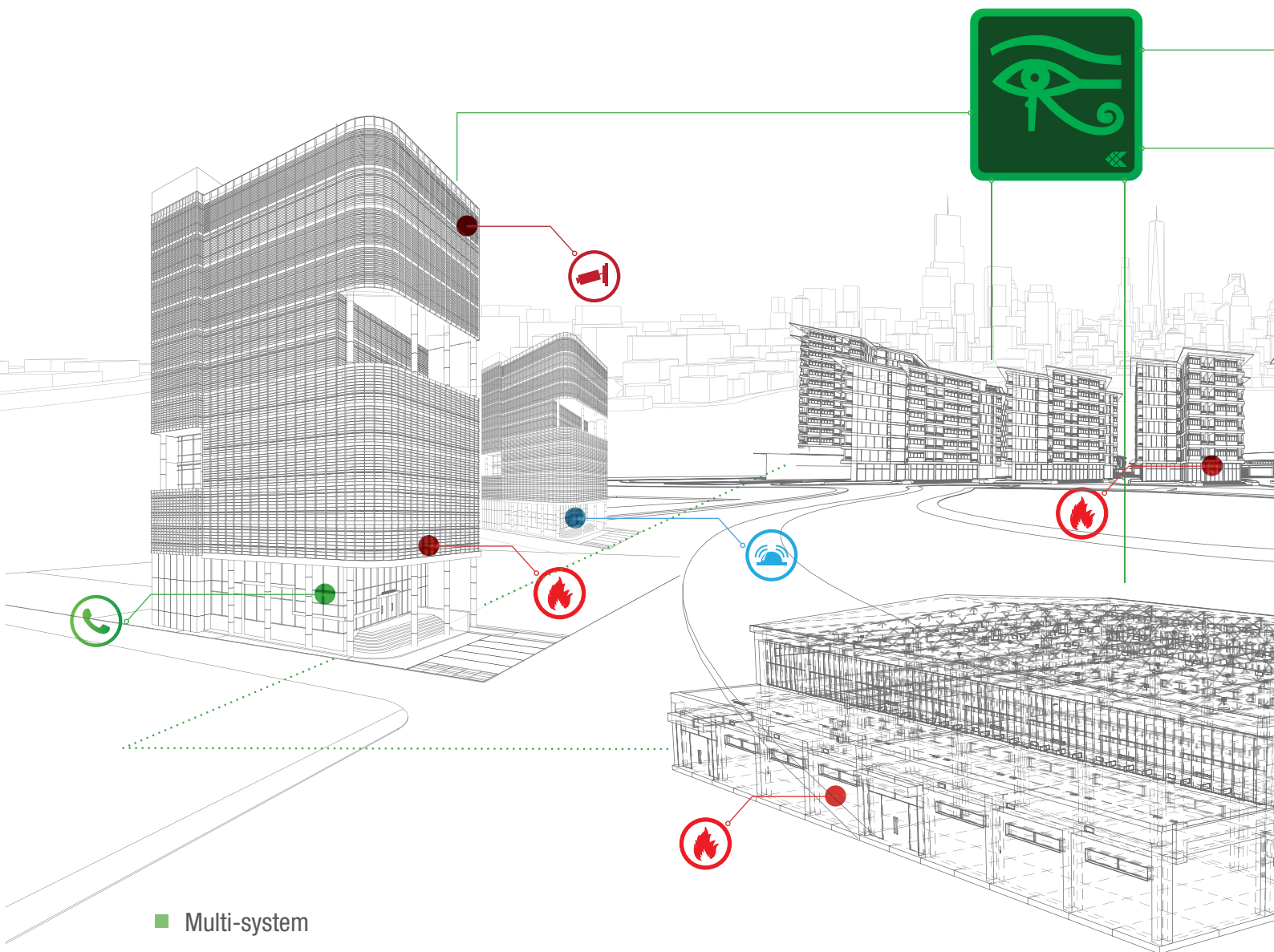

## ■ Multi-system

Very often within a single building, especially a large one, multiple systems are installed (fire protection, intruder alarm, video surveillance, video entry); Horus makes the unified and integrated management of all these systems possible, thereby making the security manager's job much easier.

## ■ Multi-site

However, Horus is not limited to a single building; on the contrary, the platform actually allows simultaneous management of systems located in different buildings scattered far and wide, from New York to Milan to Singapore, all from a single control room.



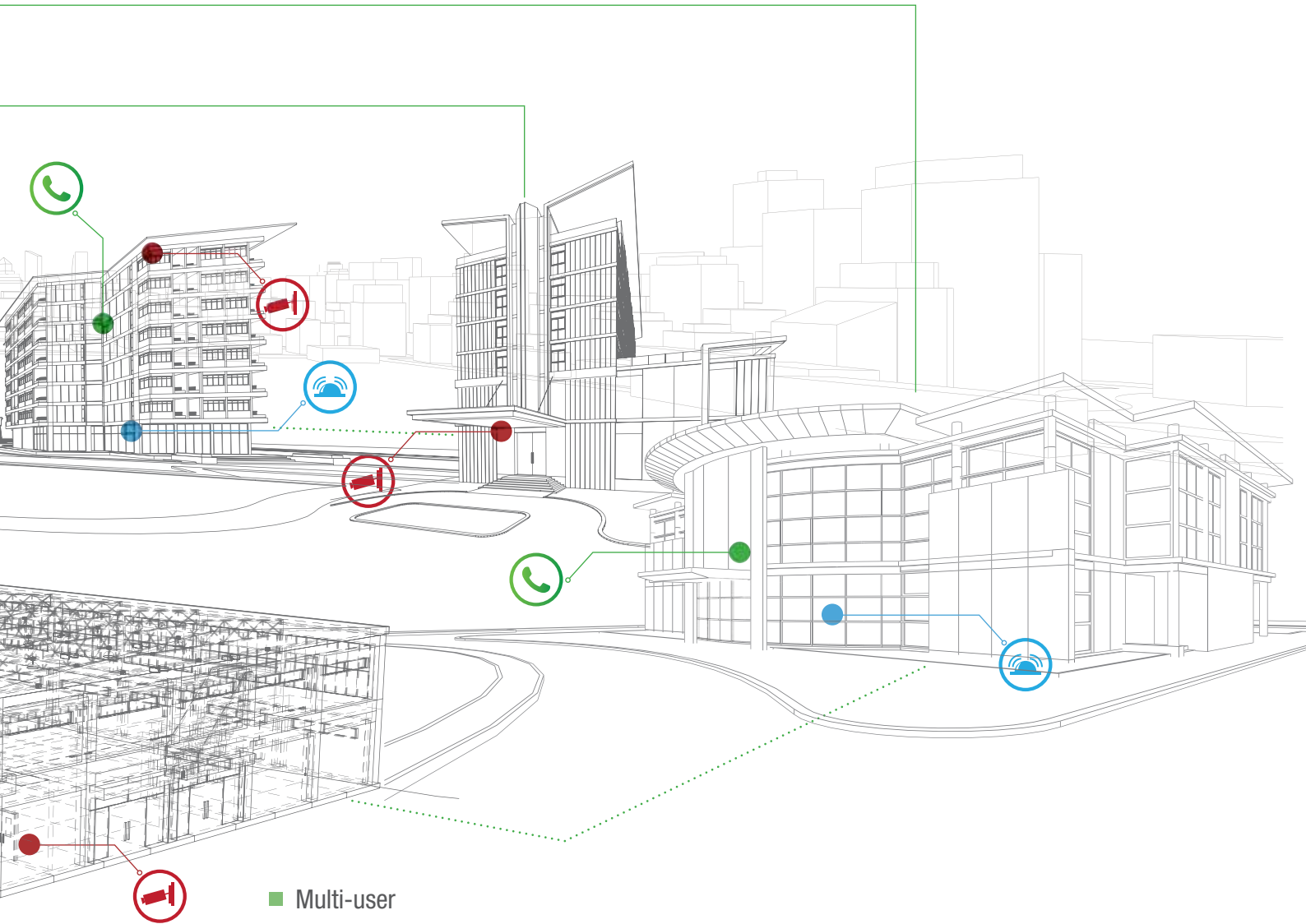

### ■ Multi-user

With the aim of guaranteeing the security of the connected site and the system itself, Horus implements user function access management based on policy levels and security groups: all this is possible thanks to the hierarchical security group > user operating setup which allows each system object (device, sensor, map, ...) to be assigned to a specific affiliated group, and every user to belong to one or more groups. This means every user will only be able to access information relevant to them, and that several users will be able to manage different scenarios or sites independently at the same time without the information being shared. The security policy settings can also be used to enable the different program functions for each individual operator, as they are used to comprehensively define the operating level of each user connected.

# A PLATFORM THAT GROWS WITH YOUR REQUIREMENTS

The countless customisation options offered by Horus can be used to adapt the software to the requirements and size of any property you want to protect. The server-client system architecture actually means that an unlimited number of clients can be connected, with several users connected at once. Plus, in the event of future expansion or new building integration, Horus can be upgraded easily by customising individual licences.





USER



CLIENT



CLIENT



CLIENT



SERVER



USER



CLIENT



CLIENT



USER



CLIENT



CLIENT



USER

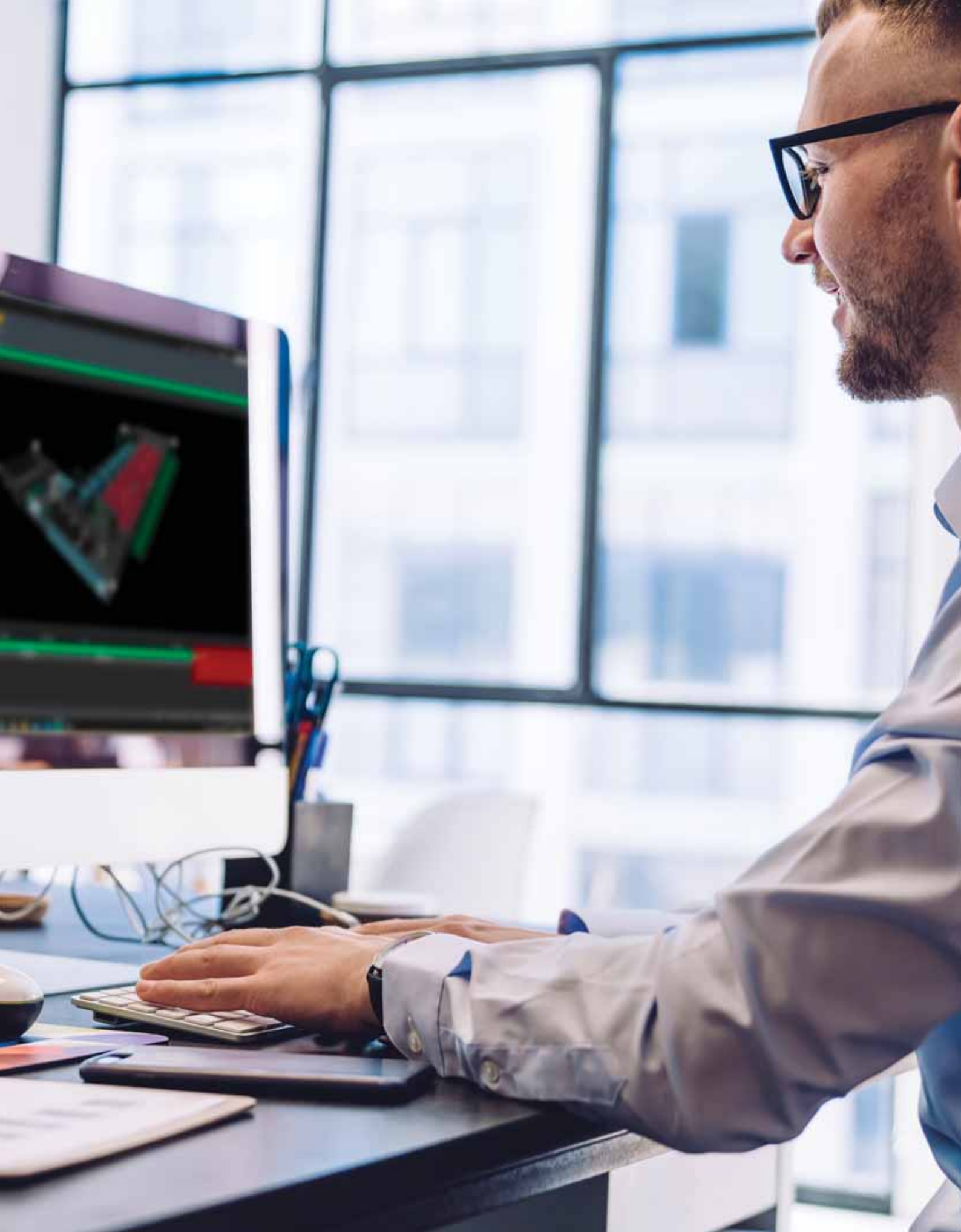





# THE SOFTWARE THAT MAKES YOUR JOB EASIER

The Horus monitoring software offers multiple advantages:

- Unified management of several systems
- Utmost usage flexibility
- User-friendly interface
- Real-time location and identification of the cause of the alarm
- Optimisation of time and costs linked to human resources
- Can also be used by operators who do not possess specific technical skills
- Automated temperature control for increasingly smart and environmentally sustainable building management, and an ensuing reduction in environmental impact
- Simplified management via graphic maps

# SECURITY IN A MAP

- The platform interface is based on graphic maps which faithfully reproduce the area to be monitored, as well as the position of the various devices and sensors making up the security system.
- This system can be used to quickly indicate the location and cause of the alarm, making it easier for the operator to view the information and manage the various events.
- Integration with the video surveillance system also automatically shows the user the camera closest to the event in progress, to view live video and recordings of the period immediately preceding the event, thereby allowing rapid identification of the cause and the gravity of the alarm.
- Not simply event viewing, but also device management: sensor commands and monitor system faults can actually be executed directly.





Comelit Horus

Windows - Advanced search - About... - Comelit H

Navigation Edit

Home map Default view Show full map Map

Alarm logs Event logs Report anomalies Logs

Areas Manage

Actual status Sensor mode

Alarm status Videowall

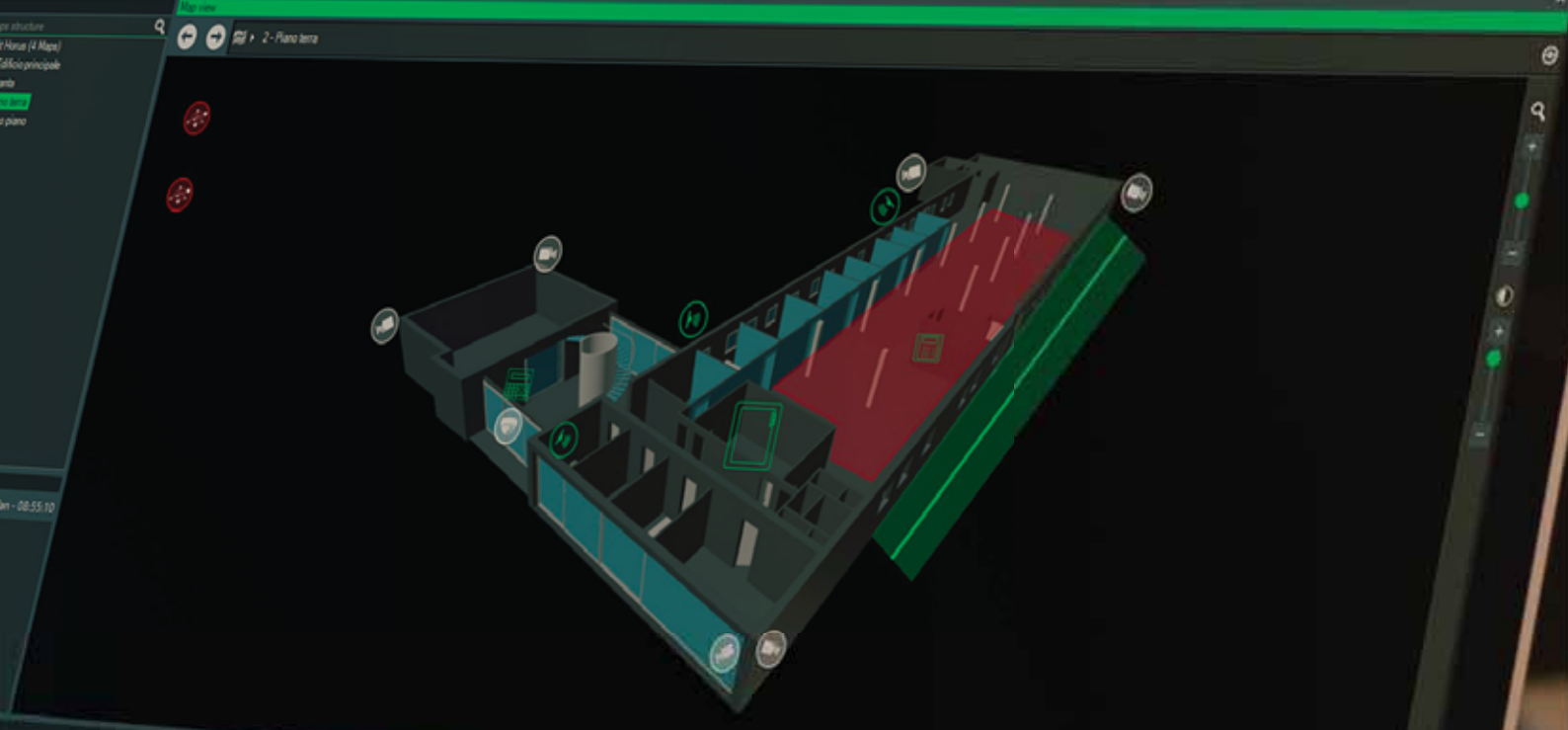

Area name	Building	Number	Description	Text	Message
PETROBRAS	0	Sensor 30		Alarm	
ANALISVIDEO	0	Perimetro21		Motion Alarm	

**Alarm**

Sensor 30  
Alarm

00:55:09

Taskbar with icons for File Explorer, Edge, and other applications.

System tray: RAM, CPU, DESKTOP-NUXKTT7SCSQL, 00:55 AM, ENG, IT, 28/01/2021





«Come  
**HO**



Soft  
+ m







# SYSTEM INTEGRATION

Integrating the video surveillance system with the intruder alarm and fire protection systems is the ideal solution when it comes to providing outstanding prevention and keeping the people inside the building safe. For example, following a fire alert from any device, Horus can be used to enable viewing of the closest camera, for instant event verification. You can also program automations and custom scenarios based on your own requirements, such as switching on certain lights to assist in evacuating people from the building using a specific route, unlocking exits, inhibiting ventilation or playing a voice message. Prevention and security, but also access management: integration with the IP video system actually allows centralised management of entrances and exits, making it possible to open all access points in the event of an alarm and to view the external unit cameras.

Finally, for all-round control, advanced reports can be generated and downloaded, with custom filters available for the various events indicated by the software and for the activities carried out within the program.



# COMELIT AT YOUR SERVICE

Given the complexity of the systems that can be managed with Horus and the extensive customisation that can be applied using the software, the Comelit sales network and projects and specifications office are fully available to assist in finding the most suitable solution for all requirements and to construct the platform according to the needs of each customer.

## Want to know more?

Scan the QR code and contact your local sales team

Sales network





# Comelit worldwide

## **Comelit Group S.p.A. Headquarter**

Via Don Arrigoni,5  
24020 Rovetta – San Lorenzo(BG) ITALY

+39 0346 750011  
+39 0346 71436

[www.comelitgroup.com/it-it](http://www.comelitgroup.com/it-it)  
[info@comelit.it](mailto:info@comelit.it)

## **Comelit Immotec France**

18, rue Séjourné  
94000 Creteil Cedex  
FRANCE

+33 01-43-53-97-97  
+33 01-43-53-97-87

[www.comelit.fr](http://www.comelit.fr)  
[contact@comelit-immotec.fr](mailto:contact@comelit-immotec.fr)

## **Comelit Group UK Ltd**

Unit 2B The Quad, Butterfield Business Park,  
Luton, Bedfordshire, LU2 8DL

+44(0)1707377203  
+44(0)1707377204

[www.comelitgroup.co.uk](http://www.comelitgroup.co.uk)  
[sales@comelitgroup.co.uk](mailto:sales@comelitgroup.co.uk)

## **Comelit USA (USA and Canada)**

2021 S. Myrtle Avenue  
Monrovia, CA91016  
USA

+1 (626)930-0388  
+1 (626)930-0488  
+1 (888)692-9739

[www.comelitusa.com](http://www.comelitusa.com)  
[info@comelitusa.com](mailto:info@comelitusa.com)

## **Comelit South East Asia**

Victory Centre  
110 Lorong 23 Geylang, #05-10  
388410 Singapore

+6567024780

[www.comelit.sg](http://www.comelit.sg)  
[enquiries@comelit.sg](mailto:enquiries@comelit.sg)

## **Comelit Hong Kong**

Representative Office  
Room 204, 2/F, Won Hing Building,  
74-78 Stanley Street,  
Central, Hong Kong

+852 2583 9998

[www.comelit.hk](http://www.comelit.hk)  
[info@comelit.hk](mailto:info@comelit.hk)

## **Comelit Malaysia**

Representative Office  
Jalan Pinang, 50450 Kuala Lumpur, Malaysia.

+03-21615128

[www.comelit.sg](http://www.comelit.sg)  
[enquiries@comelit.sg](mailto:enquiries@comelit.sg)

## **Comelit Nederland BV**

Buitendijks 1  
3356 LX Papendrecht  
NETHERLANDS

+31 (0)78 6511201  
+31 (0)78 6170955

[www.comelit.nl](http://www.comelit.nl)  
[info@comelit.nl](mailto:info@comelit.nl)

## **Comelit Group Belgium**

Kleinewinkellaan 24  
1853 Grimbergen  
BELGIUM

+32 2 411 50 99  
+32 2 411 50 97

[www.comelit.be](http://www.comelit.be)  
[info@comelit.be](mailto:info@comelit.be)

## **Comelit Ireland**

Ground floor 14 Herbert Str.  
Dublin 2  
IRELAND

+353 1619 0204  
+353 1619 0298

[www.comelit.ie](http://www.comelit.ie)  
[info@comelit.ie](mailto:info@comelit.ie)

## **Comelit Middle East**

Office EG-08 DSO HQ  
Dubai, UAE

+97143331114

[www.comelit.ae](http://www.comelit.ae)  
[info@comelit.ae](mailto:info@comelit.ae)

## **Comelit Australia Pty Ltd**

Melbourne Office and Showroom  
Unit 6, 11 Sabre Drive  
Port Melbourne Victoria 3207  
Sydney Office and Showroom  
Unit 23, 56-58 O'Riordan Street  
Alexandria NSW 2015

Ph. 1300 889 000  
Int. +613 9909 4500

[enquiries@comelitgroup.com.au](mailto:enquiries@comelitgroup.com.au)

## **Comelit Group S.p.A. Sucursal en España**

Calle Pintor Roig I Soler 28  
08916 Badalona, Barcelona  
SPAIN

+34 932430376  
+34 934084683

[www.comelit.es](http://www.comelit.es)  
[info@comelit.es](mailto:info@comelit.es)

## **Comelit Group S.p.A. Deutschland**

Konrad-Zuse-Str. 2  
41516 Grevenbroich  
Deutschland

Tel. 0 21 82-82 96-0  
Fax: 0 21 82-82 96-299

[www.comelit.de](http://www.comelit.de)  
[info@comelit.de](mailto:info@comelit.de)

## **Comelit Telergo Security Ltd**

Roumelis 59,16451  
Argyroupoli  
GREECE

+30 210 99 68 605 – 6  
+30 210 99 45 560

[www.comelit.gr](http://www.comelit.gr)  
[telergo@otenet.gr](mailto:telergo@otenet.gr)

## **Comelit Russia**

Bagratiyevskiy 7, Moscow, Russia

Tel: +74996382705

[www.comelit.ru](http://www.comelit.ru)  
[info@comelit.ru](mailto:info@comelit.ru)

## **Comelit Vietnam**

Representative Office  
496/9/12 Duong Quang Ham, Phuong 6,  
Quan Go Vap, HCMC

[www.comelit.vn](http://www.comelit.vn)  
[enquiries@comelit.sg](mailto:enquiries@comelit.sg)



[www.comelitgroup.com](http://www.comelitgroup.com)



The brands and trade names cited in this publication are the property of their respective owners.  
Product dimensions derived from the images are purely indicative.